

FEATURES

- | Construction utilizes void-free molded plastic technique
- | Low reverse leakage
- | High forward surge current capability

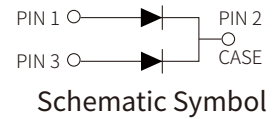
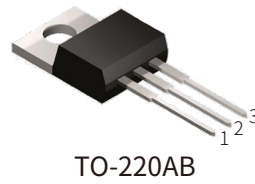

MECHANICAL DATA

- | Case : Molded plastic body
- | Polarity : Polarity symbol marking on body
- | Mounting Position : Any

APPROVALS

RoHS	Compliance with 2011/65/EU
HF	Compliance with IEC61249-2-21:2003

MAXIMUM RATINGS AND CHARACTERISTICS (T_A=25°C)

Parameter	Symbol	MUR 2005CT	MUR 2010CT	MUR 2020CT	MUR 2040CT	MUR 2050CT	MUR 2060CT	Unit
Marking		MUR 2005CT	MUR 2010CT	MUR 2020CT	MUR 2040CT	MUR 2050CT	MUR 2060CT	
Maximum repetitive peak reverse voltage	V _{RRM}	50	100	200	400	500	600	V
Maximum RMS voltage	V _{RMS}	35	70	140	280	350	420	
Maximum DC blocking voltage	V _{DC}	50	100	200	400	500	600	
Maximum average forward rectified current at T _c =110°C	per device	20.0						A
	per diode	10.0						
Surge peak forward current, 8.3ms single half sine-wave superimposed on rated load per diode	I _{FSM}	200.0						A
Maximum instantaneous forward voltage at 10.0A	V _F	1.0			1.5	2.0		V
Maximum DC reverse current at rated DC blocking voltage	T _A =25°C	10						μA
	T _A =125°C	500						
Maximum reverse recovery time	T _{rr}	35			50			ns
Typical thermal resistance	R _{θJC}	3.5						°C/W
Operating junction and storage temperature range	T _J , T _{STG}	-55 to +150						°C

Note 1: Reverse recovery time test condition: IF=0.5A IR=1.0A Irr=0.25A

CHARACTERISTIC CURVES

Fig. 1- Derating Curve Output Rectified Current

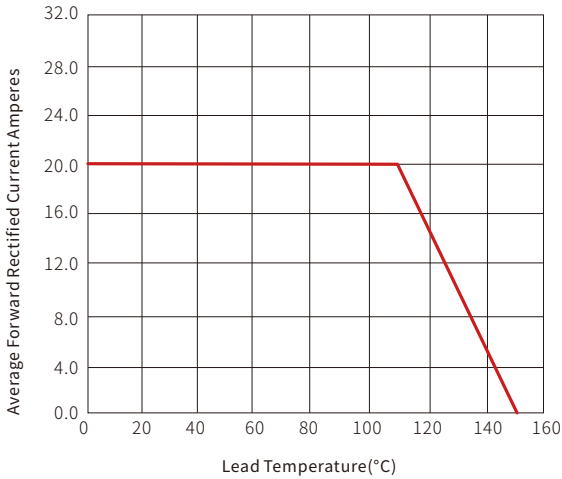

Fig. 2- Maximum Non-Repetitive Peak Forward Surge Current Perleg

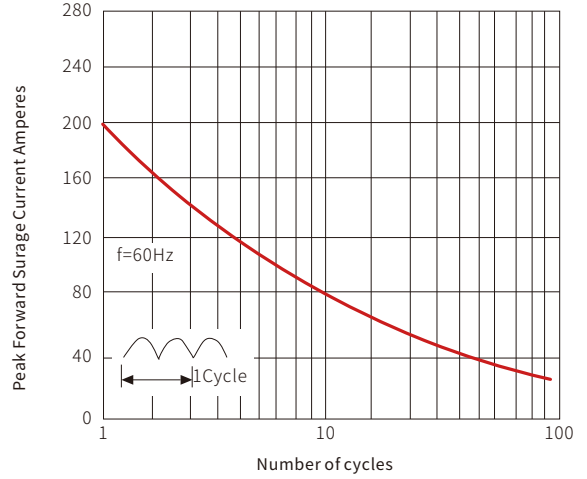

Fig. 3- Typical Forward Voltage Characteristics

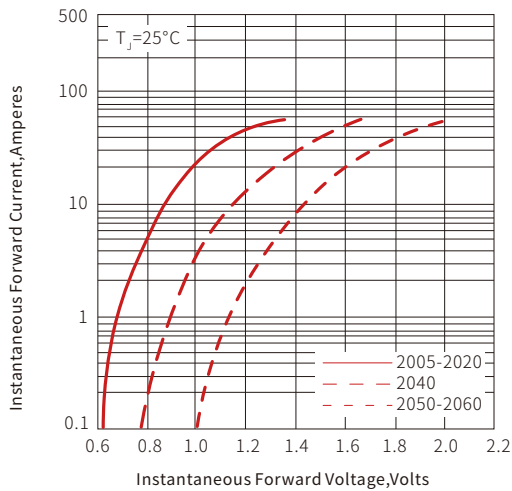
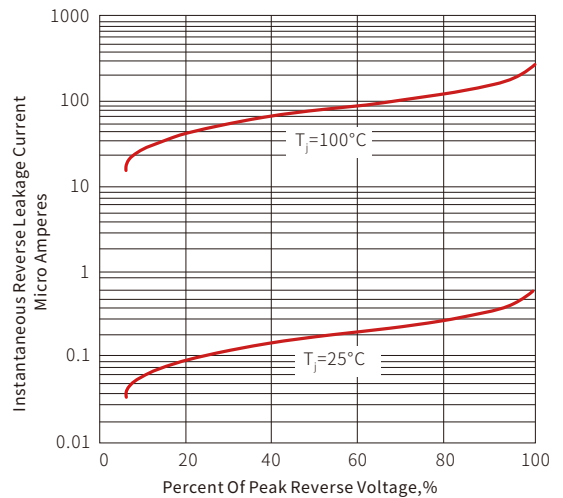
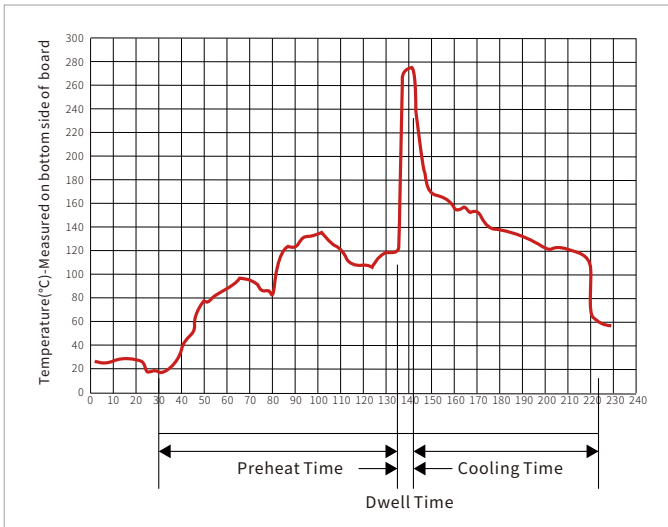

Fig. 4- Typical Reverse Leakage Characteristics



WAVE SOLDERING



Wave Parameter		Lead-free assembly
Pre Heat	Temperature Min	100°C
	Temperature Max	150°C
	Time(min to max)	60 – 180 secs
Solder pot Temperature		280°C Max
Solder Dwell Time		2-5 seconds

TO-220AB PACKAGE MECHANICAL DATA

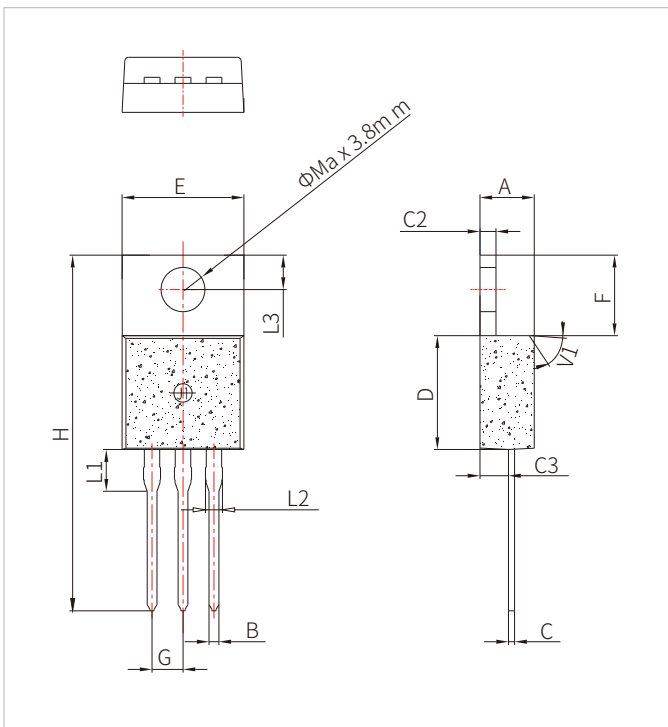

Ref.	Dimensions					
	Millimeters			Inches		
	Min.	Typ.	Max.	Min.	Typ.	Max.
A	4.40		4.60	0.173		0.181
B	0.61		0.88	0.024		0.035
C	0.46		0.70	0.018		0.028
C2	1.21		1.32	0.048		0.052
C3	2.40		2.72	0.094		0.107
D	8.60		9.70	0.339		0.382
E	9.80		10.4	0.386		0.409
F	6.55		6.95	0.258		0.274
G		2.54			0.1	
H	28.0		29.8	1.102		1.173
L1		3.75			0.148	
L2	1.14		1.70	0.045		0.067
L3	2.65		2.95	0.104		0.116
V1		45°			45°	

ORDERING INFORMATION

Part Number	Package	Qty/pcs		
		Tube	QTY/Box	Q'TY/Carton
MUR2005CT-MUR2060CT	TO-220AB	50	1000	5000

Headquarters

No.3387 Shendu Road
Pujiang I&E Park
Minhang Shanghai China
201000

Hotline

400-021-5756

Web

<https://www.semiware.com>

Sales Center

Tel: 86-21-3463-7458
Email: sales18@semiware.com

Customer Service

Tel: 86-21-5484-1001
Email: sales17@semiware.com

Technical Support

Tel: 86-21-3463-7654
Email: fae01@semiware.com

Complaint & Suggestions

Tel: 86-21-3463-7172
Ext: 8868
Email: cs03@semiware.com

By QR Code

Website



Wechat

To find your local partner within Semiware's global website: www.semiware.com

© 2022 Semiware Semiconductor Inc.

The content of this document has been carefully checked and understood. However, neither Semiware nor its subsidiaries assume any liability whatsoever for any errors or inaccuracies of this document and the consequences thereof. Published specifications are subject to change without notice. Product suitability for any area of application must ultimately be determined by the customer. In all cases, products must never be operated outside their published specifications. Semiware does not guarantee the availability of all published products. This disclaimer shall be governed by substantive Chinese law and resulting disputes shall be settled by the courts at the place of business of Semiware. Latest publications and a complete disclaimer can be downloaded from the Semiware website. All trademarks recognized.